



WITH OPEN ASPECT VIEWS! This three bedroom semi-detached family home is ideally positioned on Fernwood Avenue. Within popular Garden Village, Fernwood Avenue, tucked just off Hollywood Avenue is well placed close to excellent local schooling and just a short walk from Marks & Spencer, ASDA Superstore and Regent Centre Metro Station as well as the amenities of Gosforth High Street itself.

The accommodation briefly comprises: entrance porch through to entrance hall with stairs to first floor; sitting room with walk in bay, stripped wood flooring and feature fireplace; kitchen diner measuring close to 18ft with spot lighting and French doors leading out to the conservatory, kitchen area with a range of fitted units and work surfaces; conservatory with French doors leading out to the garden; utility room with double doors to the rear garden; downstairs WC; integral storage with double doors to the front driveway. The first floor landing gives access to; three bedrooms, bedrooms one and two both comfortable doubles; family bathroom complete with four piece suite.

Externally, a gravelled front driveway and lawn and to the rear, a generous garden laid mainly to lawn with a patio seating area and hedge boundaries. Early viewings are advised to avoid disappointment!

Semi-Detached Family Home | 1,015 Sq ft (94.3m2) | Three Bedrooms | Sitting Room | Kitchen Diner | Conservatory | Utility Room | Downstairs WC | Storage | Family Bathroom | Front Garden & Driveway | Generous Rear Garden | Open Aspect Views | Popular Location | Freehold | Council Tax Band C | EPC: D

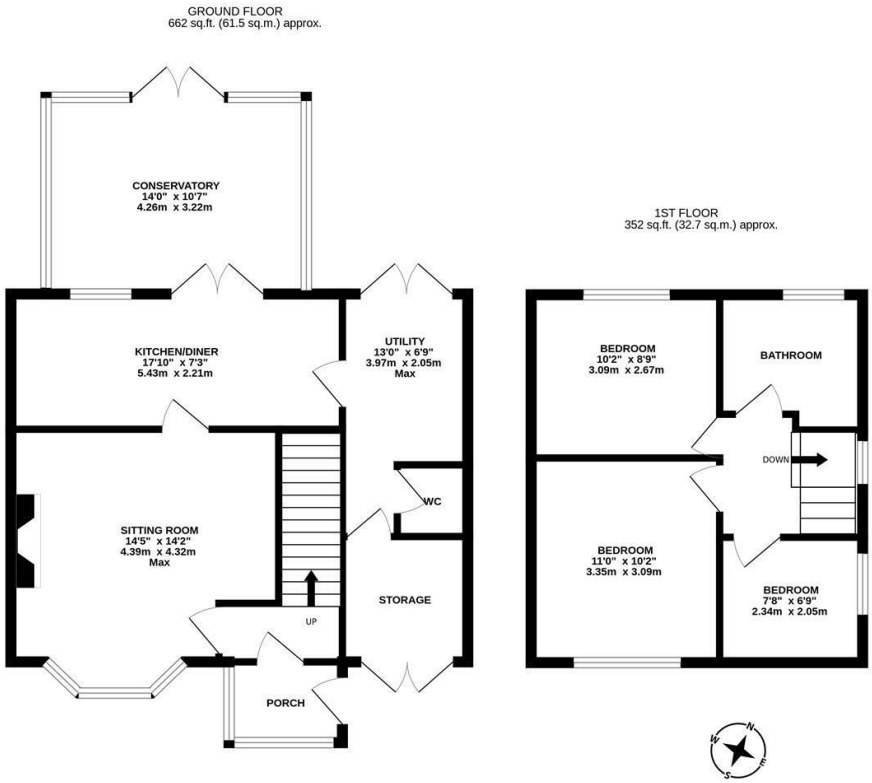

Offers Over £295,000

IMPORTANT NOTE: These particulars and the descriptions and measurements herein do not constitute representation and whilst every effort has been made to ensure accuracy, this cannot be guaranteed.

